



**CBF-HP SERIES  
CHEMICAL BY-PASS FEEDER  
(POT FEEDER)**

*Axiom's Chemical By-Pass Feeder delivers chemicals to any closed loop system. Maintaining a chemically balanced hydronic system has never been easier.*

**Max Pressure and Temperature:** 300psi (2.07MPa) at 200°F (93°C)

**Connections:** FNPT (3/4")



**FEATURES and BENEFITS**

- *Allows for safe and easy chemical dosing.*
- *Ball valve for easy chemical dosing and pot feeder isolation*
- *Wide opening for adding dry chemical*
- *Graduated funnel with stainless steel filter for clean, accurate, and mess free chemical addition*
- *Pressure vessel and fittings made with brass and Carbon steel*
- *2 Gallon (7.6 litre) and 5 Gallon (18.9 litre) models available*
- *Wall bracket available for 2 Gallon (7.6litre) model*
- *5 Gallon (18.9L) model comes with adjustable steel legs.*

TOLL FREE: (877) 651-1815 PHONE: (306) 651-1815 EMAIL: info@axiomind.com

[www.axiomind.com](http://www.axiomind.com)



# INDUSTRIES LIMITED

	Model	Size	Pressure Vessel Volume	Max Pressure
<input type="checkbox"/>	<b>CBF-2-HP</b>	¾"	2 gal (7.6L)	300psi (2.07MPa)
<input type="checkbox"/>	<b>CBF-5-HP</b>	¾"	5 gal (18.9L)	300psi (2.07MPa)

## SPECIFICATION

Chemical By-Pass Feeder shall be AXIOM INDUSTRIES LTD. model CBF-\_\_\_\_\_-HP. System shall include carbon steel chemical by-pass feeder, ¾" NPT carbon steel tee, two ¾" NPT carbon steel nipples, ¾" NPT brass ball valve, 1/4" NPT brass ball valve, and 20 US oz.(600 mL) polyethylene graduated funnel with integral 20 mesh strainer and ¾" NPT connection. The CBF series pot feeder is not for use with potable water. Model CBF-5-HP series comes with three 17.6" (44.7cm) long adjustable steel legs.

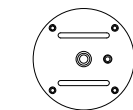
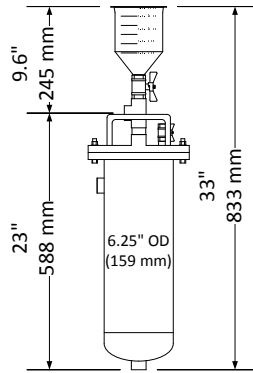

CBF-2-HP

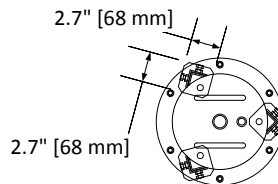
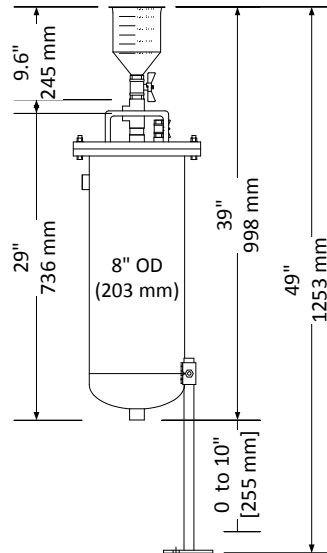

CBF-5-HP

## ACCESSORIES

- CBF-B** – Wall mount bracket for the CBF-2 or CBF-2-HP

## LIMITED WARRANTY

The Axiom CBF Chemical By-Pass Feeder is warranted against defects in materials and workmanship for one year.

Project \_\_\_\_\_ Location \_\_\_\_\_  
 Consultant \_\_\_\_\_ Contractor \_\_\_\_\_  
 Unit Tag \_\_\_\_\_ Sales Agent \_\_\_\_\_