



PEXPAL TUBING ORGANIZER BRACKET TECHNICAL INFORMATION

INSTRUCTIONS :

Each manifold station requires one PexPal module per loop and one End Plate per manifold (E.g. 8 loops manifold requires 8 PexPals and 1 End Plate). Each PEX-Pal module supports the supply and return pipe for one loop.

Line up each module in the proper orientation and firmly press them flush together. Add the end plate if one of the open sides remain exposed. Fasten the block of modules firmly to decking, rebar, ready-rod, temporary manifold support or wooden form using screws. Push the free end of the tubing through the channel guide on the PEX-Pal and connect it to the supply manifold. Proceed to lay the tubing circuit and slide the return line in the second channel guide before connecting to the return manifold.

DIMENSIONS :

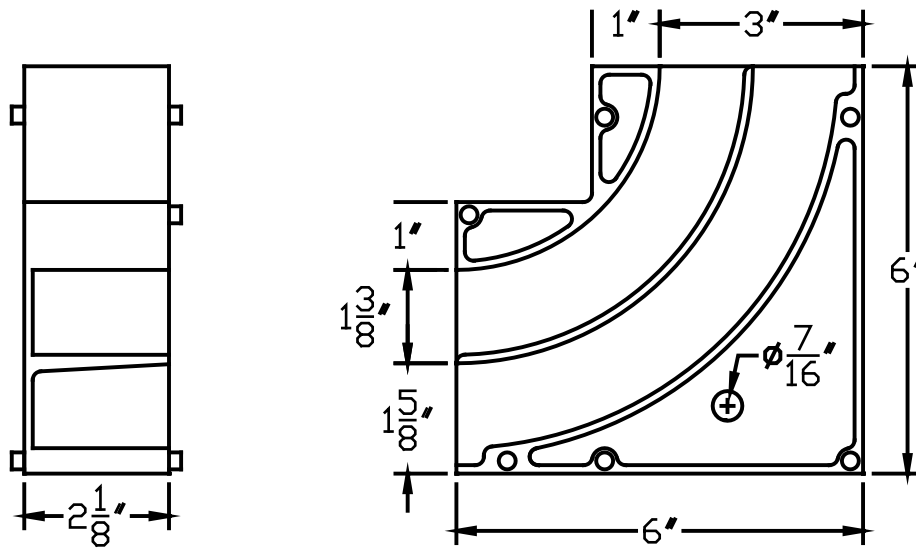

WEIGHT : 0.294 kg, 0.65 lbs

SPECIFICATION :

PEXPal tubing bend supports shall be used at all manifold stations. The support shall maintain a bend radius larger than the manufacturers' recommended minimum for 3/4" and smaller PEX pipe. A two-channel design shall keep the supply and return pipes separate and position them at the correct spacing required for connection to the manifold. Modules shall be press fit together and shall be reversible to allow for PEX piping to be connected from front or back. The enclosed design shall protect the tubing at the floor surface. The organizer shall be installed at a fixed position, which ensures a minimum distance of 1" between the top of the slab and the top of the PEX tubing. Supports to be Axiom Industries Ltd. PEX-Pal.

LIMITED WARRANTY :

The PEXPal is warranted against defects in materials and workmanship for one year.

Project _____
Consultant _____
Unit Tag _____

Location _____
Contractor _____
Sales Agent _____